

Friends of Bolton Street Cemetery Inc.

P.O. BOX 2336, WELLINGTON

Newsletter No.14, May 1983

ANNUAL GENERAL MEETING.

Date: Monday May 30th.

Venue: St. Andrew's on the Terrace.

Time: 7.30p.m.

Speaker will be Mrs. M. Alington.

All members are urged to attend.

PRESS STATEMENT given to Evening Post

Several forward steps to effect a long-promised addition to the Bolton Street Memorial Park have been announced by the Chairman of the Friends of Bolton Street Cemetery, Mr Hugh Fullarton. The Friends are seeking an early incorporation into the Park of adjoining lands owned by the Dairy and Meat Boards and the Reserve Bank.

Last month, with a view to assisting the City Council and the land owners concerned, the Friends resolved to prepare a proposal for an extension of the Memorial Park with a frontage to Bolton and Mowbray Streets. The new area of open space would be formed over a car-park building of one to three stories accessible from those streets. This proposal has now been presented to the City Council, the N.Z. Dairy and Meat Boards, the Reserve Bank, and the University Grants Committee.

The development scheme submitted by the Friends has been designed by a Wellington architect Mr Helmut Einhorn. It makes provision for the formation of an attractively landscaped area near the heart of the City, and for the accommodation of about 220 cars below that area. Surplus parking lots would be available for use other than by the present land owners.

When inviting interested parties to meet with them to discuss the development proposal, the Friends expressed the hope that it would be accepted "in principle". Thereafter, the Friends added, the City Council would be expected to prepare working drawings and cost estimates (either by Council staff or Consultants), to get agreement on the allocation of cost with the land owners involved, to proceed with the calling of tenders in the near future, and to handle all financial matters.

continued on back page-

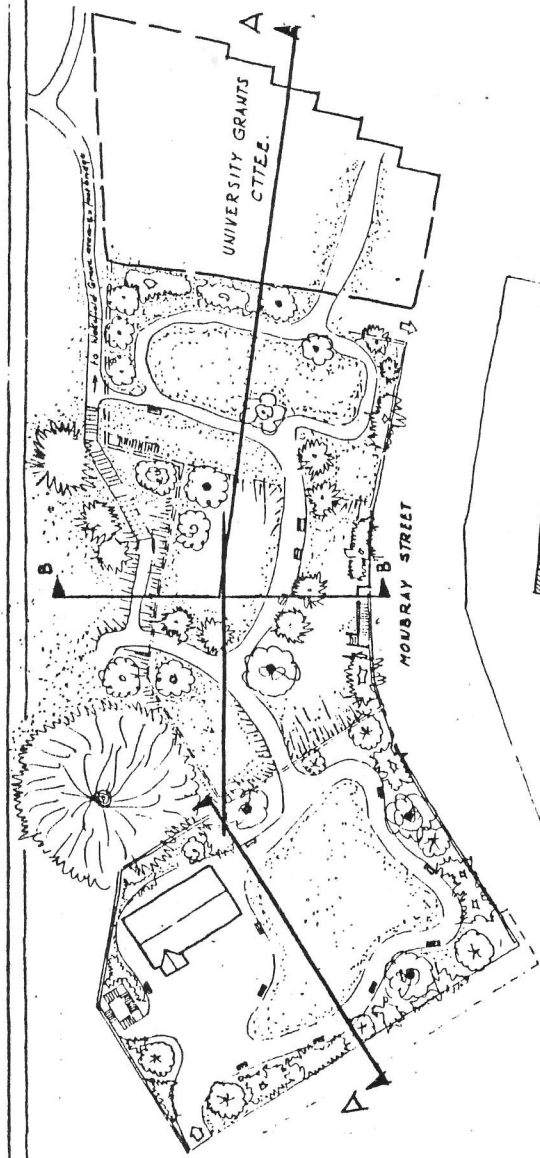
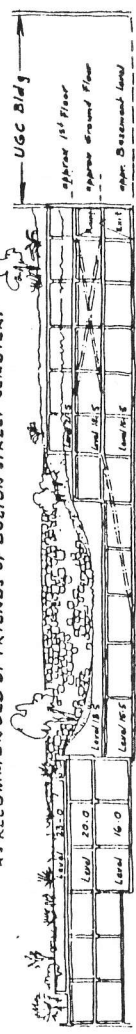
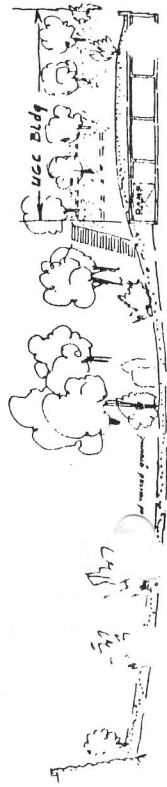

TABLE	
NO. OF CLEARINGS	
1	49
2	63
3	22
4	106

LAYOUT OF MEMORIAL PARK EXTENSION
AS RECOMMENDED BY FRIENDS OF BOLTON STREET CEMETERY



LONGITUDINAL SECTION ON A-A (showing additional 21.5' level and ramps)



SECTION ON B-B

FRIENDS OF BOLTON ST CEMETERY
SCHEME PLAN SHOWING EXTENSION OF
BOLTON STREET MEMORIAL PARK
OVER CAR PARKING FACILITY ON
BOLTON AND MOWBRAY STREETS

SHEET 1. SCALE 1:200

Drawn on behalf of Friends of Bolton St Cemetery,
by H. ELLIOTT, F.R.I.B.A., M.A.S.T.P., F.I.C.I.A., March 1953

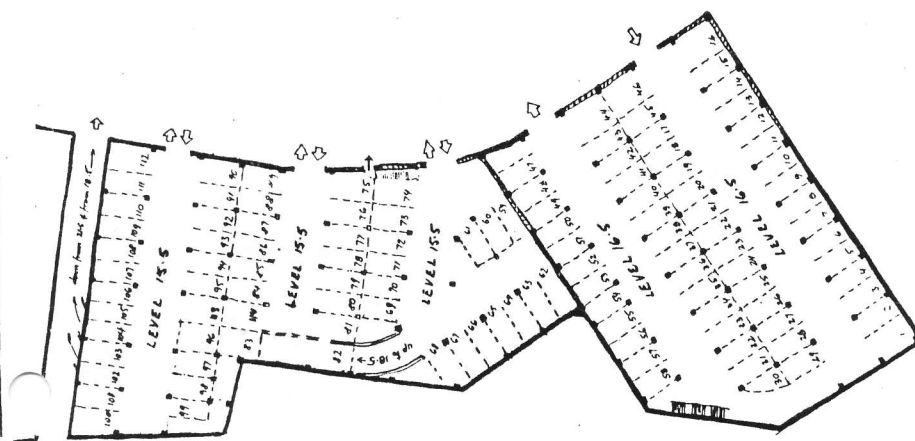
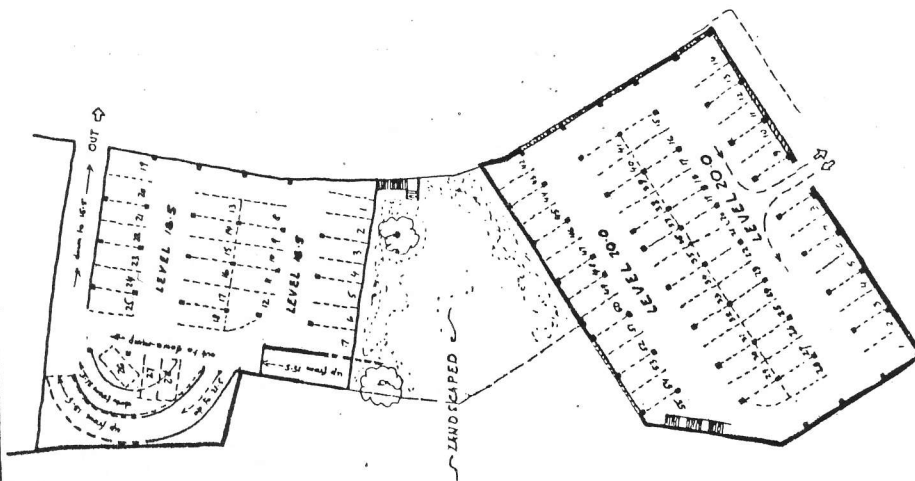
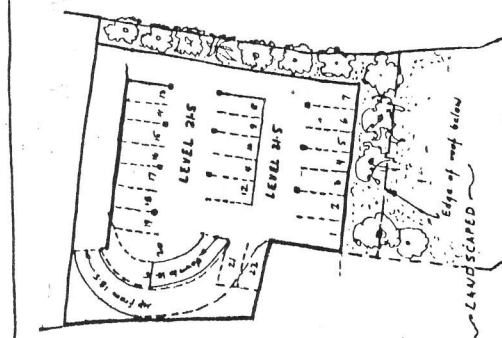

PLAN OF INTERMEDIATE LEVEL

PLAN OF LOWER LEVEL

FRIENDS OF BOLTON STREET CEMETERY — SCHEME PLAN SHOWING EXTENSION OF BOLTON ST. MEMORIAL PARK OVER CARPARKING FACILITY ON BOLTON AND MOWBRAY STREETS — PARKING FLOOR PLANS AS RECOMMENDED BY "THE FRIENDS"

Donated on behalf of Friends of Bolton St. Cemetery by Education

evaluated by Council officers and will then be considered by Council as a whole. The Friends anticipate a favourable response, as the addition of promised Mowbray Street lands to the Memorial Park has long been an objective of Council, and the Council too has had the provision of off-street parking in this area much in mind. The Council, moreover, is aware that the Dairy and Meat Boards would be ready to consider a Memorial Park extension combined with an underground car-park.

The General Manager of the Dairy Board has described the Society's proposed development scheme as "an admirable solution to the problem". He has expressed the Producer Boards readiness to make their freehold land available to the City Council or Government (or indeed to any other responsible body with sufficient assets to fulfill undertakings given) in exchange - on a peppercorn rental basis - for a 99 year lease in a car-parking building of the same number of car parks as are currently enjoyed.

The Reserve Bank has advised the Friends that it is currently having discussions with the City Council on the future of the Mowbray Street area. The attitude of the Bank to the Friends proposal is not yet known.

The Chairman of the University Grants Committee has stated that the authority intends to operate from its present location for the foreseeable future and is not really an interested party to discussions on the Friend's plan. Although the plan now presented does not affect Grants Committee land, it is the earnest hope of the Friends of Bolton Street Cemetery that, should the Committee vacate their present office building, steps would be taken to include that land also within the Memorial Park. Only thus indeed, will promises made by the National Roads Board and Government in the 1960's be fully honoured.

Over the past six years, the fulfillment of deeply significant promises has been repeatedly and strongly urged by the Friends of Bolton Street Cemetery. Numerous written and personal representations have been made to Ministers of the Crown, His Worship the Mayor and Town Clerk, and the land owners concerned. The Friends have tried hard to assist a resolution of this problem by exploring a possible exchange of Mowbray Street land for alternative sites within the City. For various reasons however, these efforts have been fruitless.

It must always be remembered that in 1967 - against most powerful opposition - four acres of an historic City reserve were taken free of cost for the construction of the Wellington Urban Motorway: and, although the Mowbray Street lands are only about 3/4 acre in extent, it was undoubtedly the promise of those very lands to the City which, in large measure, led to an acceptance of the motorway project by Wellingtonians.

It is the firm hope of the Friends of Bolton Street Cemetery that planning procedures will now be expedited so that the extension of the Bolton Street Memorial Park and the reconstruction of the historic Chapel may be carried out with the least possible delay. Members of the Society and of several kindred Societies are confident that the additional open space which will thus be made available for recreation and leisure will be greatly valued by the citizens of Wellington and by visitors to the Capital City.

Hugh A. Fullarton,
Chairman, Friends of Bolton Street Cemetery (Inc),
21 April, 1983.

Registered at P.O.H.Q. Wellington as a magazine